

10-32 COAXIAL CONNECTOR

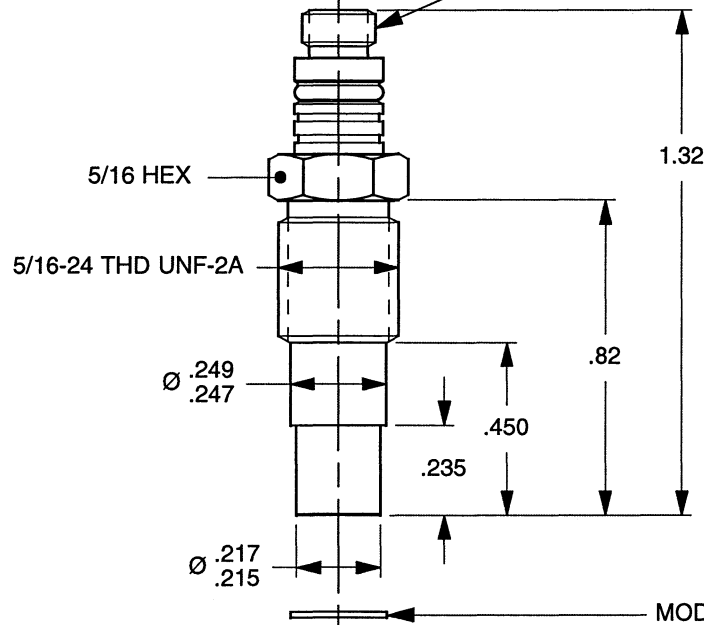

MOD 6600 SEAL, BRASS

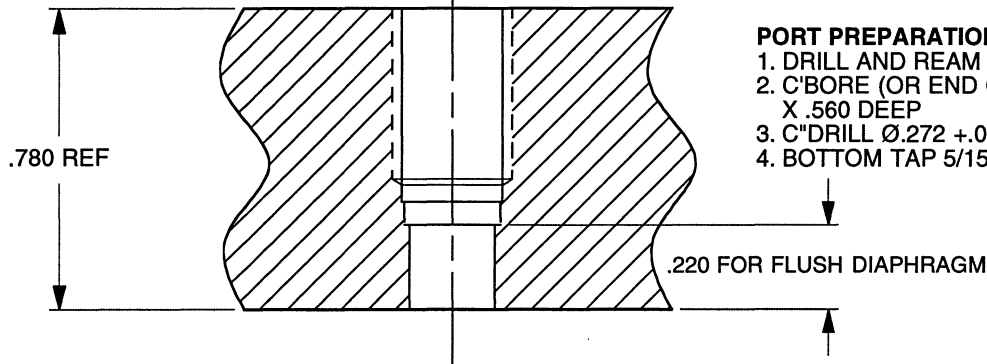

PORT PREPARATION INSTRUCTIONS, 2200V 1

1. DRILL AND REAM $\text{Ø}.221 +.001/-.000$ THRU
2. C'BORE (OR END CUTTING REAM) $1/4$ ($\text{Ø}.250$) X .560 DEEP
3. C'DRILL $\text{Ø}.272 +.003/-.001$ X .500 DEEP
4. BOTTOM TAP 5/15-24 UNF-2B X .440 MIN DEPTH

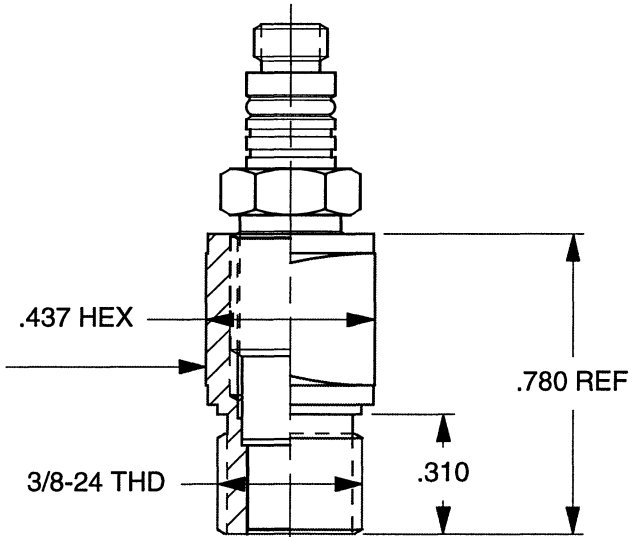

MOD 6601 SEAL, BRASS

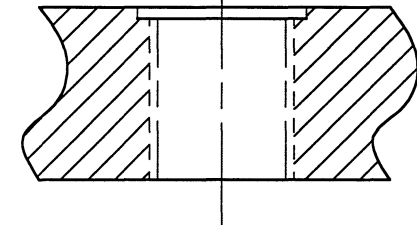

PORT PREPARATION INSTRUCTIONS, 6502

1. DRILL Q ($\text{Ø}.332$) THRU (OR .450 MIN DEPTH)
2. TAP 3/8-24 UNF-2B X .350 MIN DEPTH
3. C'BORE $\text{Ø}.437 +.003/-.000$ X .030 DEEP

2. MOUNTING TORQUE FOR 6502 ADAPTOR: 50-60 LB-INCHES.

1. MOUNTING TORQUE FOR 2200C PROBE: 30 LB-INCHES.



**MASTER
ONLY IF IN RED**

CHATSORTH, CA.



SCALE 2X	REV -	DATE 1/22/04	ECN -		
DATE 1/22/04	PART NO.				
DRAWN R.A.	CHECKED N.C.	MAT'L			
APPROVED 126-04	NEXT ASSEMBLY			USED ON	

**OUTLINE/INSTALLATION DRAWING,
MODEL 2200C**

DWG NO.

127-2200C

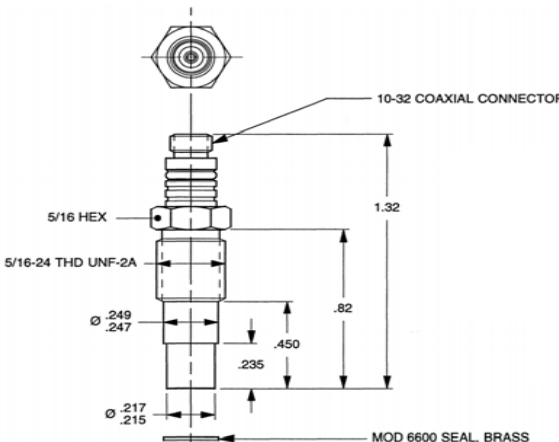
SHEET 1 OF 1

MODEL NUMBER 2200C1		PERFORMANCE SPECIFICATION				DOC NO. PS2200C1																																																		
		CHARGE MODE PRESSURE SENSOR				REV B, ECN 16130, 08/25/21																																																		
		<ul style="list-style-type: none">• WIDE TEMPERATURE RANGE• ACCELERATION COMPENSATED• MINIATURE SIZE																																																						
		<table><thead><tr><th colspan="2">ENGLISH</th><th colspan="2">SI</th></tr></thead><tbody><tr><td>Weight, Max</td><td>0.25</td><td>oz</td><td>7</td><td>grams</td><td></td><td></td></tr><tr><td>Mounting Provision</td><td>5/16 UNF-2A</td><td></td><td>5/16 UNF-2A</td><td></td><td></td><td></td></tr><tr><td>Connector [1]</td><td>10-32 Coaxial</td><td>Type</td><td>10-32 Coaxial</td><td></td><td></td><td></td></tr><tr><td>Material</td><td>17-4 PH</td><td>Body</td><td>17-4 PH</td><td></td><td></td><td></td></tr><tr><td>Diaphragm</td><td>300 Series S.S.</td><td></td><td>300 Series S.S.</td><td></td><td></td><td></td></tr></tbody></table>						ENGLISH		SI		Weight, Max	0.25	oz	7	grams			Mounting Provision	5/16 UNF-2A		5/16 UNF-2A				Connector [1]	10-32 Coaxial	Type	10-32 Coaxial				Material	17-4 PH	Body	17-4 PH				Diaphragm	300 Series S.S.		300 Series S.S.													
ENGLISH		SI																																																						
Weight, Max	0.25	oz	7	grams																																																				
Mounting Provision	5/16 UNF-2A		5/16 UNF-2A																																																					
Connector [1]	10-32 Coaxial	Type	10-32 Coaxial																																																					
Material	17-4 PH	Body	17-4 PH																																																					
Diaphragm	300 Series S.S.		300 Series S.S.																																																					
		<table><tbody><tr><td>Sensitivity (±15%) [5]</td><td>1.1</td><td>pC/psi</td><td>0.16</td><td>pC/kPa</td><td></td><td></td></tr><tr><td>Calibrated Range</td><td>100</td><td>psi</td><td>689.5</td><td>kPa</td><td></td><td></td></tr><tr><td>Minimum Rise Time of Input Pulse</td><td>2</td><td>µsec</td><td>2</td><td>µsec</td><td></td><td></td></tr><tr><td>Maximum Pressure</td><td>10,000</td><td>psi</td><td>68948</td><td>kPa</td><td></td><td></td></tr><tr><td>Mounted Resonant Frequency</td><td>>250</td><td>kHz</td><td>>250</td><td>kHz</td><td></td><td></td></tr><tr><td>Linearity [2]</td><td>±1</td><td>%F.S</td><td>±1</td><td>%F.S</td><td></td><td></td></tr><tr><td>Acceleration Sensitivity, Axial Direction [4]</td><td>0.002</td><td>psi/g</td><td>0.0014</td><td>kPa/m/s²</td><td></td><td></td></tr></tbody></table>						Sensitivity (±15%) [5]	1.1	pC/psi	0.16	pC/kPa			Calibrated Range	100	psi	689.5	kPa			Minimum Rise Time of Input Pulse	2	µsec	2	µsec			Maximum Pressure	10,000	psi	68948	kPa			Mounted Resonant Frequency	>250	kHz	>250	kHz			Linearity [2]	±1	%F.S	±1	%F.S			Acceleration Sensitivity, Axial Direction [4]	0.002	psi/g	0.0014	kPa/m/s ²		
Sensitivity (±15%) [5]	1.1	pC/psi	0.16	pC/kPa																																																				
Calibrated Range	100	psi	689.5	kPa																																																				
Minimum Rise Time of Input Pulse	2	µsec	2	µsec																																																				
Maximum Pressure	10,000	psi	68948	kPa																																																				
Mounted Resonant Frequency	>250	kHz	>250	kHz																																																				
Linearity [2]	±1	%F.S	±1	%F.S																																																				
Acceleration Sensitivity, Axial Direction [4]	0.002	psi/g	0.0014	kPa/m/s ²																																																				
		<table><tbody><tr><td>Maximum Shock</td><td>10000</td><td>g pk</td><td>98100</td><td>m/s² pk</td><td></td><td></td></tr><tr><td>Temperature Range [3]</td><td>-100 to +500</td><td>°F</td><td>-73 to 260</td><td>°C</td><td></td><td></td></tr><tr><td>Thermal Coefficient Of Sensitivity</td><td>0.01</td><td>% / °F</td><td>0.018</td><td>% / °C</td><td></td><td></td></tr><tr><td>Environmental Seal</td><td>Epoxy</td><td></td><td>Epoxy</td><td></td><td></td><td></td></tr></tbody></table>						Maximum Shock	10000	g pk	98100	m/s ² pk			Temperature Range [3]	-100 to +500	°F	-73 to 260	°C			Thermal Coefficient Of Sensitivity	0.01	% / °F	0.018	% / °C			Environmental Seal	Epoxy		Epoxy																								
Maximum Shock	10000	g pk	98100	m/s ² pk																																																				
Temperature Range [3]	-100 to +500	°F	-73 to 260	°C																																																				
Thermal Coefficient Of Sensitivity	0.01	% / °F	0.018	% / °C																																																				
Environmental Seal	Epoxy		Epoxy																																																					
		<table><tbody><tr><td>Capacitance, Nom.</td><td>16</td><td>pF</td><td>16</td><td>pF</td><td></td><td></td></tr><tr><td>Output Signal Polarity (Positive Pressure)</td><td>Negative</td><td></td><td>Negative</td><td></td><td></td><td></td></tr></tbody></table>						Capacitance, Nom.	16	pF	16	pF			Output Signal Polarity (Positive Pressure)	Negative		Negative																																						
Capacitance, Nom.	16	pF	16	pF																																																				
Output Signal Polarity (Positive Pressure)	Negative		Negative																																																					
		<p>This family also includes:</p> <table><thead><tr><th>Model</th><th>Sensitivity (pC/psi)</th><th>Calibrated Range F.S. (psi)</th><th>Oper. Temp (°F)</th><th>Max Pressure (psi)</th></tr></thead><tbody><tr><td>2200C2</td><td>1.1</td><td>500</td><td>-100 to +500</td><td>10,000</td></tr><tr><td>2200C4</td><td>1.1</td><td>1,000</td><td>-100 to +500</td><td>10,000</td></tr><tr><td>2200C5</td><td>1.1</td><td>5,000</td><td>-100 to +500</td><td>10,000</td></tr><tr><td>2200C6</td><td>1.1</td><td>10,000</td><td>-100 to +500</td><td>15,000</td></tr><tr><td>2200C7</td><td>1.1</td><td>15,000</td><td>-100 to +500</td><td>15,000</td></tr></tbody></table> <p>Refer to the performance specifications of the products in this family for detailed description.</p> <p>NOTES:</p> <p>[1] Connector mates with Dytran cable Model 6013AXX or 6019AXX (XX= Length in feet).</p> <p>[2] Percent full scale. Zero-based best-fit straight line method.</p> <p>[3] Maximum flash temperature, short duration (as in pyroshock event), 3000°F [1649°C]</p> <p>[4] Typical. Not to exceed 0.005 psi/g [0.0035 kPa/m/s²]</p> <p>[5] All specifications are at room temperature unless otherwise specified.</p> <p>[6] In the interest of constant product improvement, we reserve the right to change specifications without notice.</p> <p>It is the customer's responsibility to validate that a particular product with the properties described in the product specification is suitable for use in a particular application. Parameters provided in datasheets and / or specifications may vary in different applications and performance may vary over time. All operating parameters, including typical parameters, must be validated for each customer application by the customer's technical experts.</p> <p>SUPPLIED ASCESSORIES:</p> <p>(2) Model 6600 Brass Seal</p> <p>RECOMMENDED ASCESSORIES:</p> <p>(1) Model 4110C Current Source Power Unit</p> <p>(2) 4751B Series in-line charge amplifier (10-32 jack to 10-32 jack)</p> <p>(3) Model 6501 & 6502 mounting adapters</p>  <p>Dimensions in brackets are in millimeters. Refer to 127-2200C for more information.</p>						Model	Sensitivity (pC/psi)	Calibrated Range F.S. (psi)	Oper. Temp (°F)	Max Pressure (psi)	2200C2	1.1	500	-100 to +500	10,000	2200C4	1.1	1,000	-100 to +500	10,000	2200C5	1.1	5,000	-100 to +500	10,000	2200C6	1.1	10,000	-100 to +500	15,000	2200C7	1.1	15,000	-100 to +500	15,000																			
Model	Sensitivity (pC/psi)	Calibrated Range F.S. (psi)	Oper. Temp (°F)	Max Pressure (psi)																																																				
2200C2	1.1	500	-100 to +500	10,000																																																				
2200C4	1.1	1,000	-100 to +500	10,000																																																				
2200C5	1.1	5,000	-100 to +500	10,000																																																				
2200C6	1.1	10,000	-100 to +500	15,000																																																				
2200C7	1.1	15,000	-100 to +500	15,000																																																				
 <div>21592 Marilla Street, Chatsworth, California 91311 Phone: 818.700.7818 Fax:818.698.0362 www.dytran.com For permission to reprint this content, please contact info@dytran.com</div>																																																								